

# Artemide®

## “O” Suspension

design  
Elemental

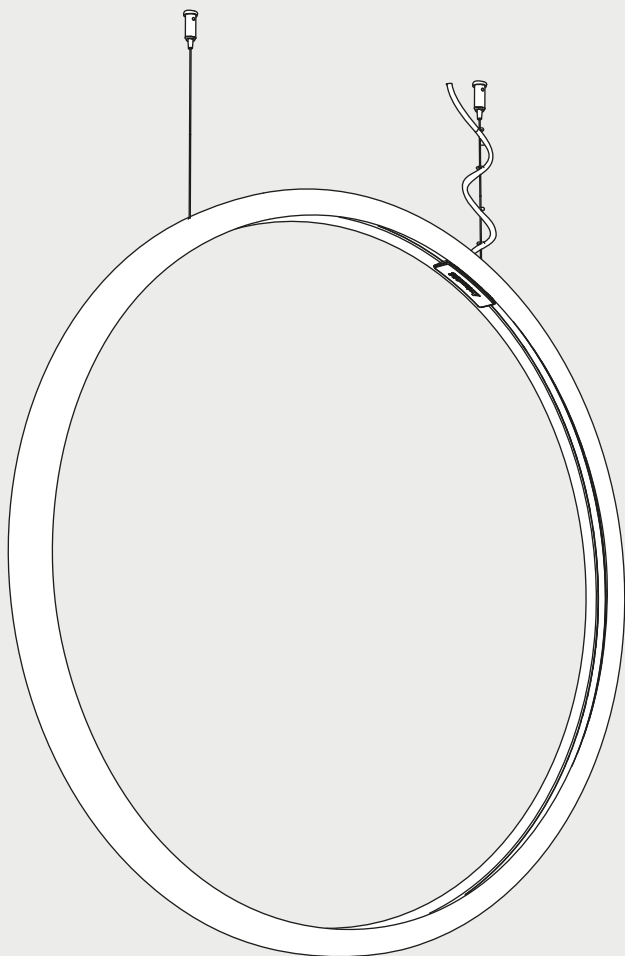

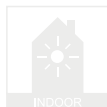

**i**

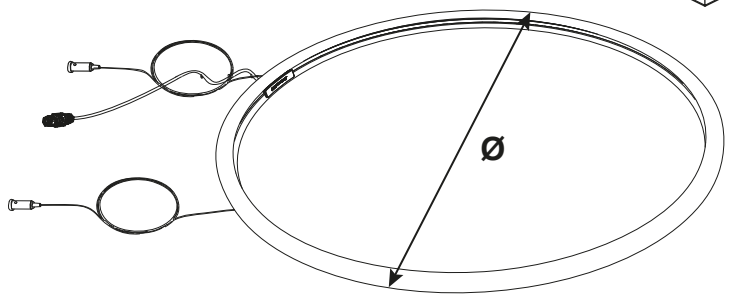
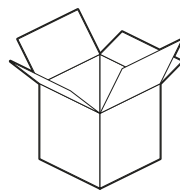
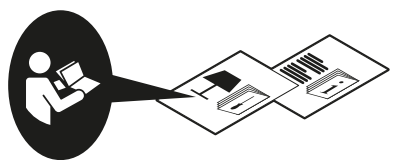
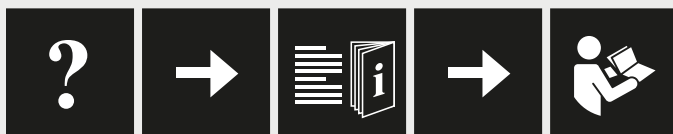

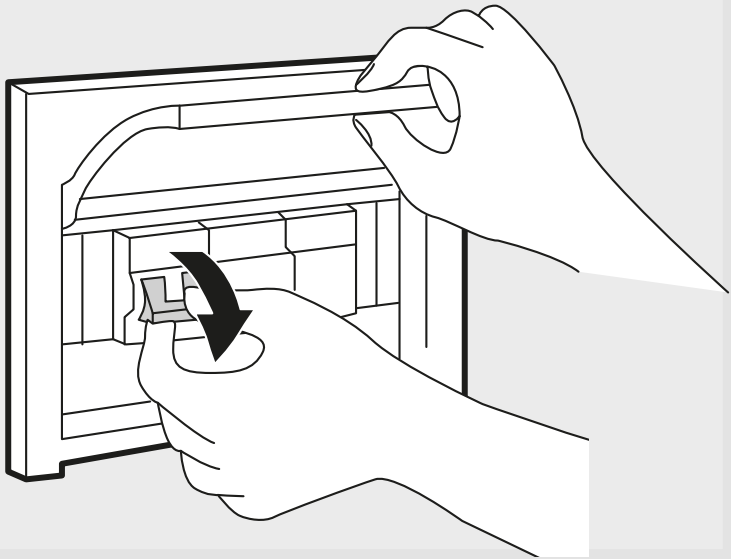

<b>T072038</b>	<b>Ø = 900 mm</b>
<b>T072238</b>	<b>Ø = 1500 mm</b>



**i**

**T072038**

U out 24 V   
Max Power 60 W  
Max Current 2,5 A

Use only with class 2 power unit   
Utiliser exclusivement avec class 2 alimentation  
Utilícese únicamente con unidad de alimentación de clase 2

**MAX 4 m**

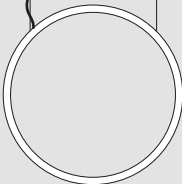

**SJTW 2XAWG18**

**Ø 7 - 13.5 mm**

20 mm

8 mm



i

T072238

U out 24 V   
Max Power 90 W  
Max Current 3,75 A

  
Use only with class 2 power unit  
Utiliser exclusivement avec class 2 alimentation  
Utilícese únicamente con unidad de alimentación de clase 2

MAX 4 m

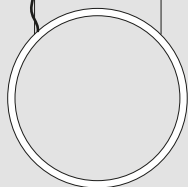

SJTW 2XAWG18

Ø 7 - 13.5 mm

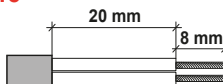

1

Ø 40 mm

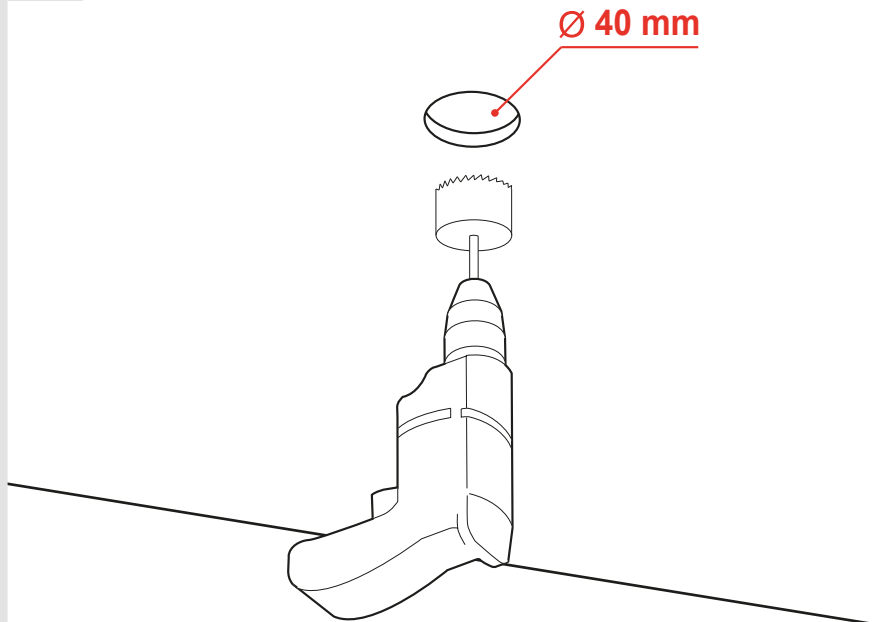

2

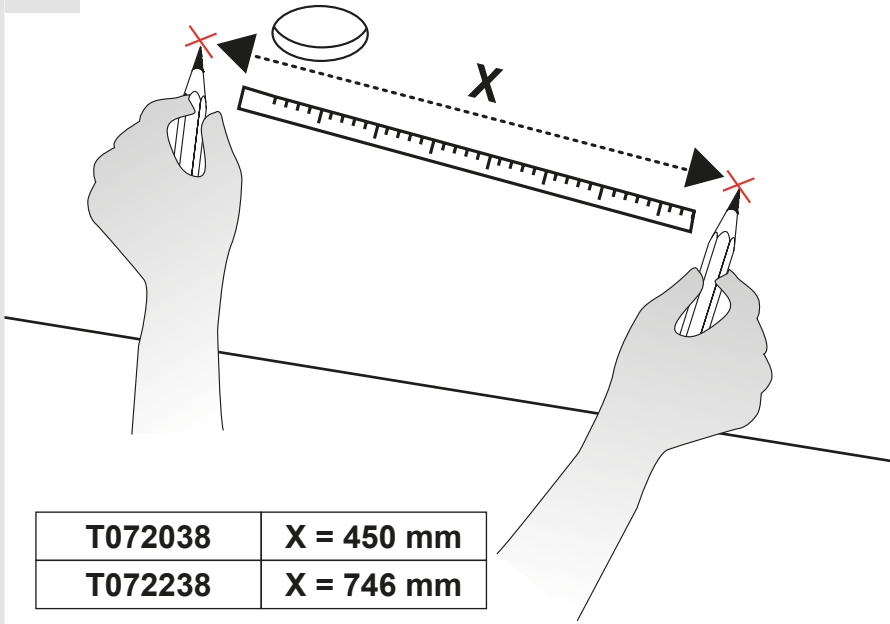

3

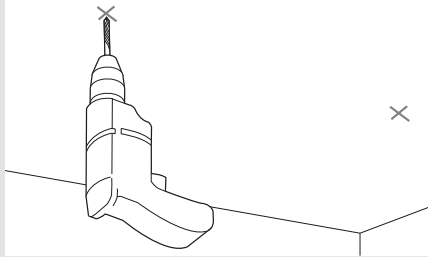

4

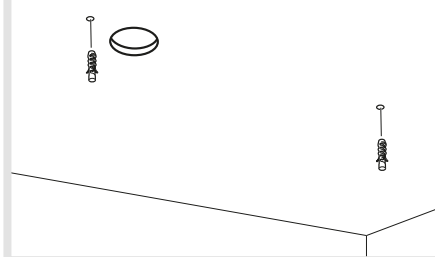

5

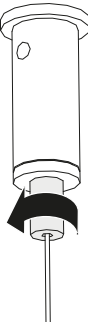

6

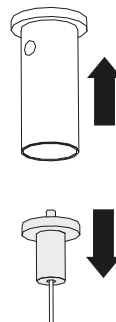

7

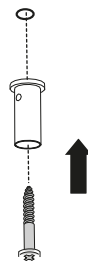
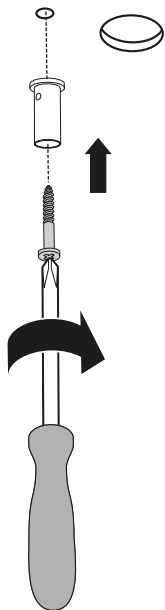

8

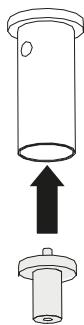

9

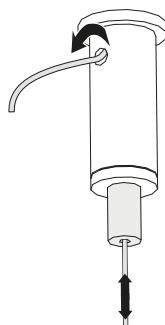

10

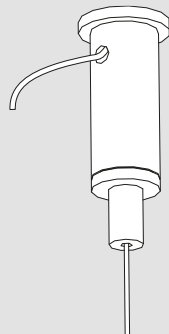
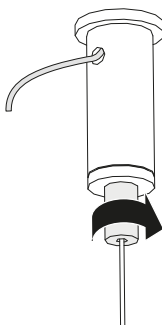

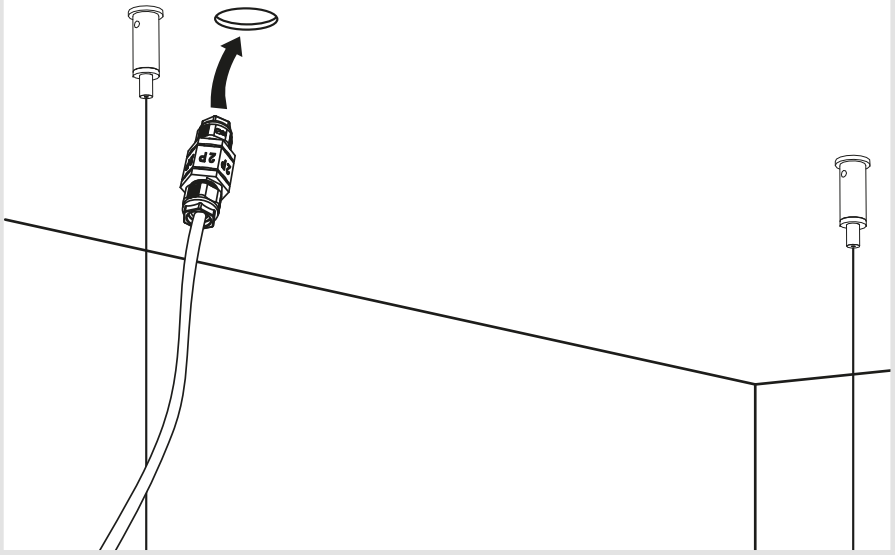

**SJTW 2XAWG18**

**Ø 7 - 13.5 mm**

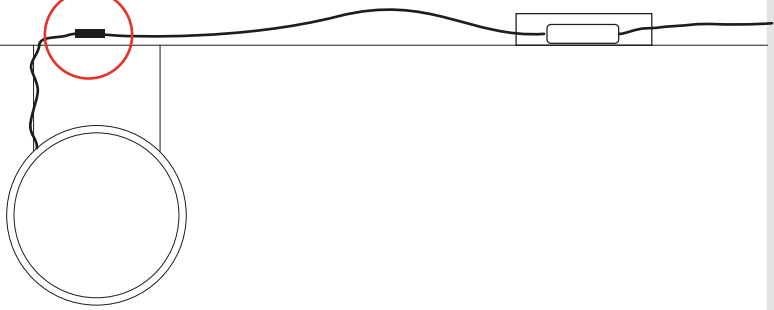
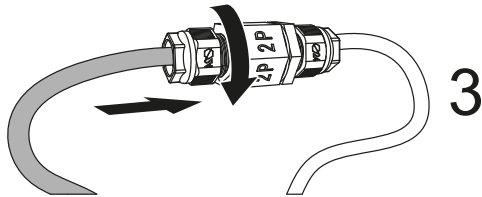
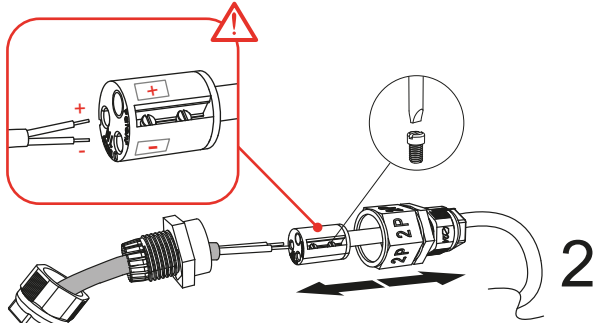
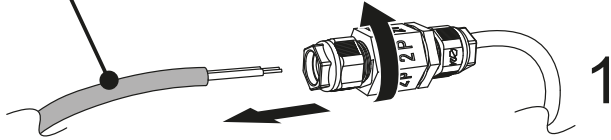
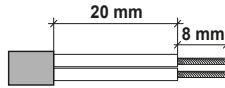



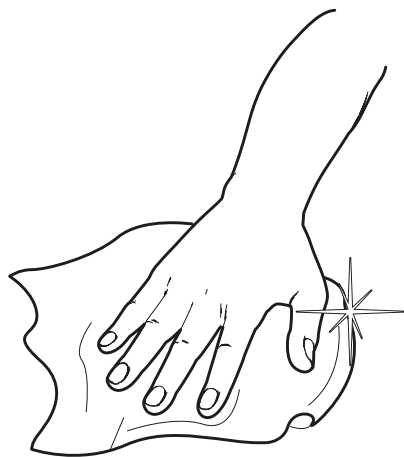
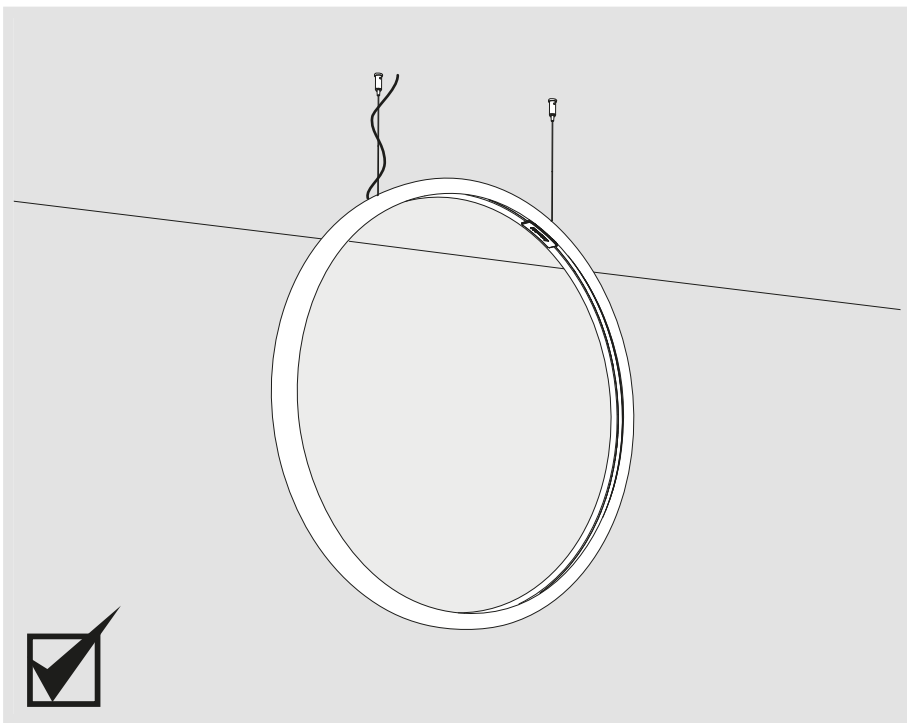

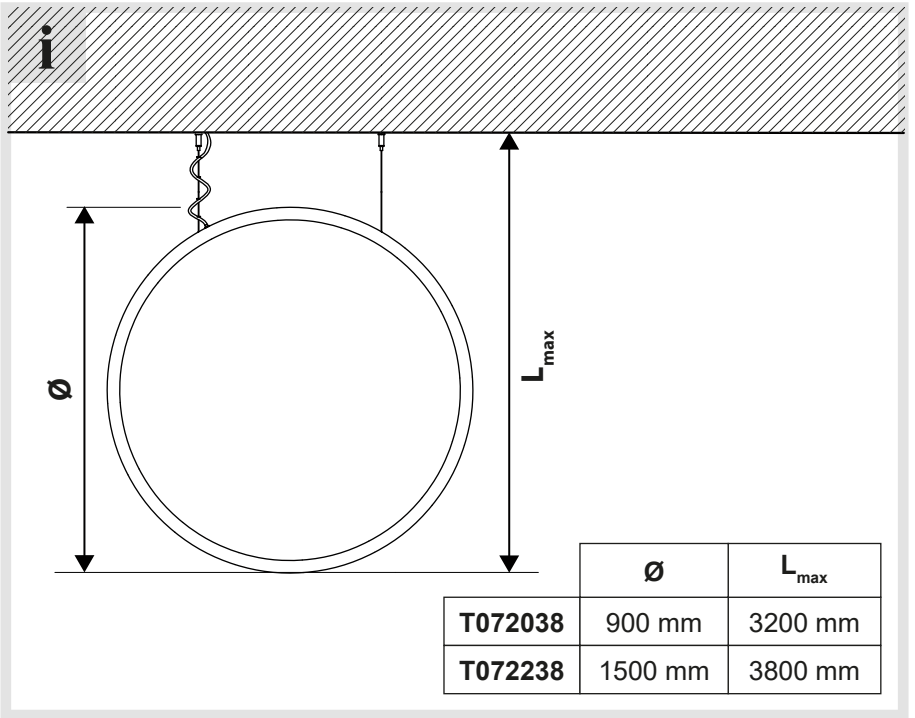



**Artemide®**



**Artemide**

via Bergamo, 18  
20010 Pregnana M.se (MI)  
ITALIA

tel. +39 02 935 181  
fax +39 02 935 90 254  
fax +39 02 935 90 496

[www.artemide.com](http://www.artemide.com)

VAT IT00846890150

cod. Y513001229A