

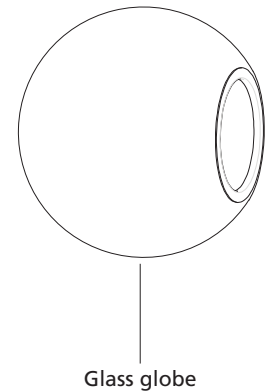

Attention: Read and understand these instructions before installing fixture. This fixture is intended for installation in accordance with National Electric Code and local regulation: To assure full compliance with local codes and regulations, check with your local electrical inspector before installation. This equipment is guaranteed only when used as indicated in these instructions; Therefore they should be kept for future reference. To prevent electrical shock, turn off power supply before carrying out any connection or maintenance operations.

MAKE SURE YOU HAVE ALL THE ELEMENTS OF THE FIXTURE

Your boxes should contain the following parts :

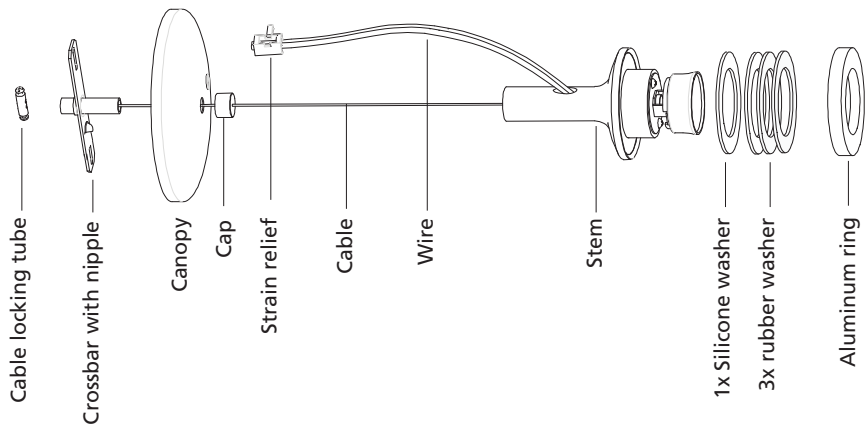

STEP 1	STEP 2	STEP 3								
<p>1. Fix the crossbar to the junction box with screws 8-32 (not included)</p>	<p>1. Adjust the length cable 2. Tighten the screws</p>	<p>1. Connect the wires 2. Install the strain relief</p>								
		<table border="1" data-bbox="1356 1549 1507 1717"> <thead> <tr> <th>FIXTURE WIRES</th> <th>CEILING WIRES</th> </tr> </thead> <tbody> <tr> <td>GREEN SCREW</td> <td>GREEN</td> </tr> <tr> <td>PLAIN</td> <td>BLACK</td> </tr> <tr> <td>WHITE</td> <td>WHITE</td> </tr> </tbody> </table>	FIXTURE WIRES	CEILING WIRES	GREEN SCREW	GREEN	PLAIN	BLACK	WHITE	WHITE
FIXTURE WIRES	CEILING WIRES									
GREEN SCREW	GREEN									
PLAIN	BLACK									
WHITE	WHITE									



Attention: Read and understand these instructions before installing fixture. This fixture is intended for installation in accordance with National Electric Code and local regulation: To assure full compliance with local codes and regulations, check with your local electrical inspector before installation. This equipment is guaranteed only when used as indicated in these instructions; Therefore they should be kept for future reference. To prevent electrical shock, turn off power supply before carrying out any connection or maintenance operations.

STEP 4

1. Adjust the nipple and screw the cap

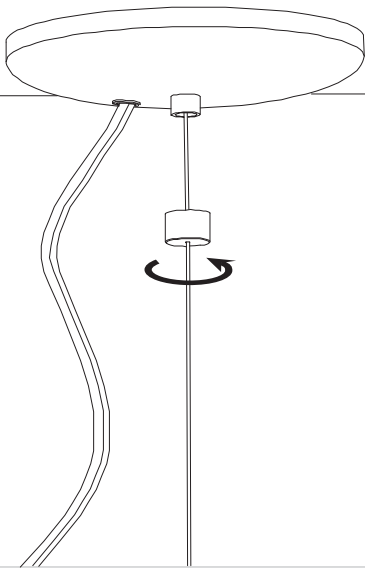

STEP 5

1. Add the silicone washer and than 2 rubber washer in the stem
2. Insert the stem into the glass
3. Add the rubber washer and screw the ring tightly

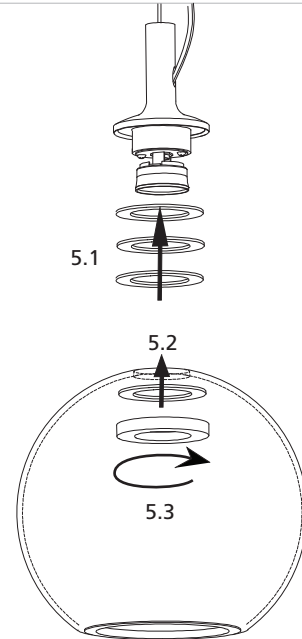

STEP 6

1. Install the lamp
(GU24 lamp or any E26 lamp)

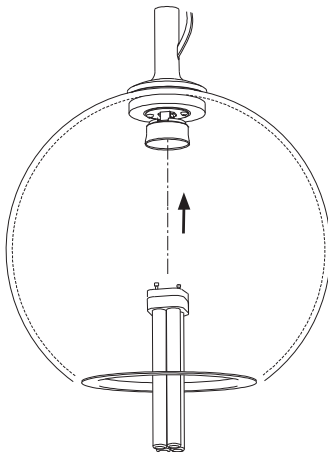

or

