

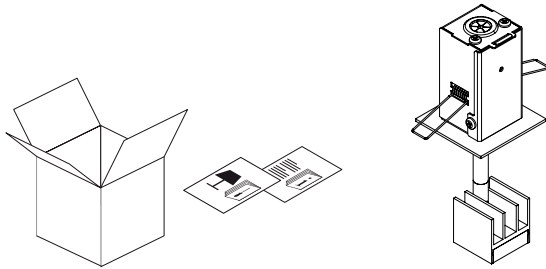

**Attention:** Read and understand these instructions before installing fixture. This fixture is intended for installation in accordance with National Electric Code and local regulation: To assure full compliance with local codes and regulations, check with your local electrical inspector before installation. This equipment is guaranteed only when used as indicated in these instructions; therefore they should be kept for future reference. To prevent electrical shock, turn off power supply before carrying out any connection or maintenance operations.

Your box should contain ;complete fixture



### STEP 1

1. Cut a circular opening in the ceiling

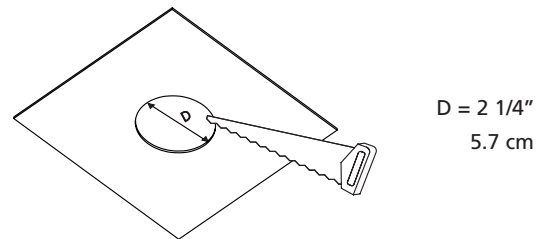

### STEP 2

1. Unscrew junction box cover and remove.

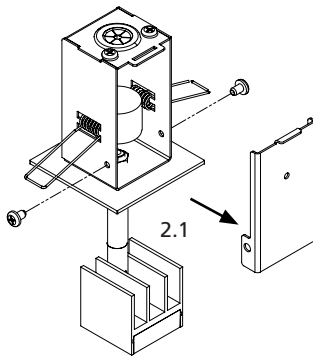

### STEP 2A

For Low-voltage wires :

1. Pass wire through bushing.
2. pass inside strain relief and tighten the screws

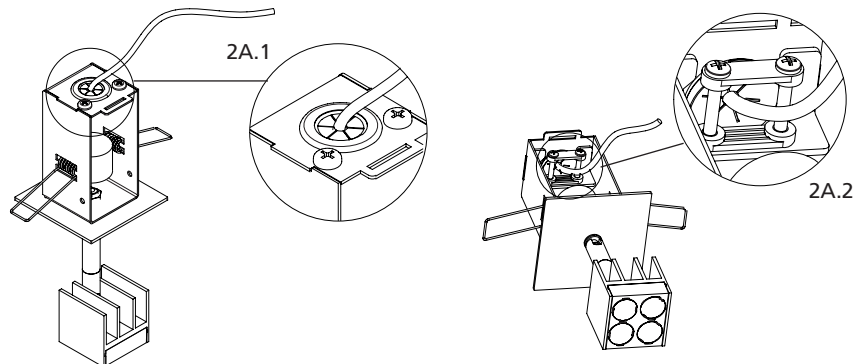

### STEP 3

1. Make appropriate connections.
2. Screw junction box cover back.

FIXTURE WIRES	CEILING WIRES
Black -	Black -
White -	White +

This luminaire is compatible with 12 Volts AC or DC circuits.

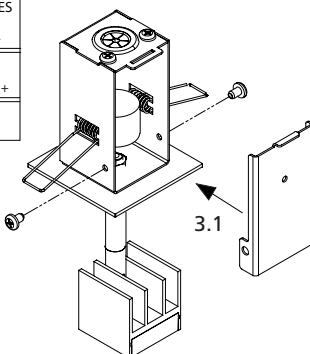

### STEP 2B

For BX conduit or Loomex wires :

1. Remove bushing, screws and strain relief bracket
2. Install BX conduit or loomex connector (not included).

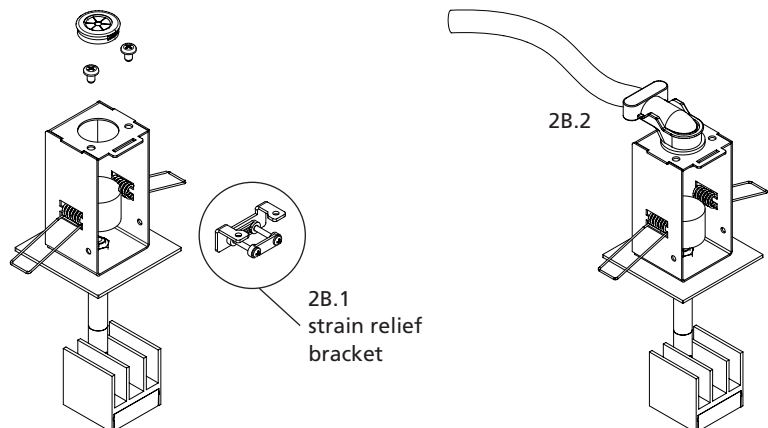



**STEP 4**

1. Push mounting springs upward.
2. Insert the fixture in the ceiling.
3. Fixture installed

