



Attention: Read and understand these instructions before installing fixture. This fixture is intended for installation in accordance with National Electric Code and local regulation: To assure full compliance with local codes and regulations, check with your local electrical inspector before installation. This equipment is guaranteed only when used as indicated in these instructions; therefore they should be kept for future reference. To prevent electrical shock, turn off power supply before carrying out any connection or maintenance operations.

Make sure you have all the elements to complete the installation. Depending on configuration selected, you must have the following:

Driver Housing

Surface model — OR — Recessed model

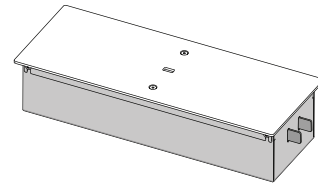
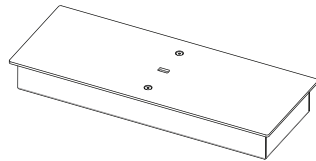

Pad Fixture

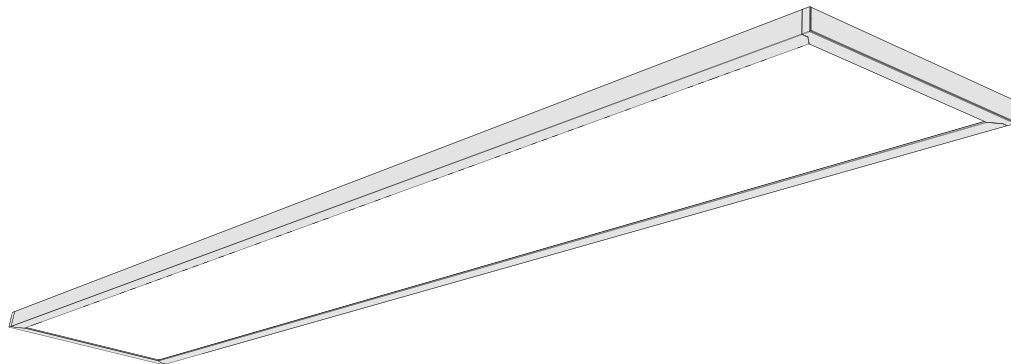

STEP 1

Install the Driver Housing, following the Instruction sheet supplied with it (document Y503-11401).

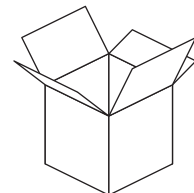
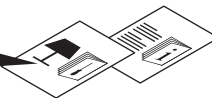
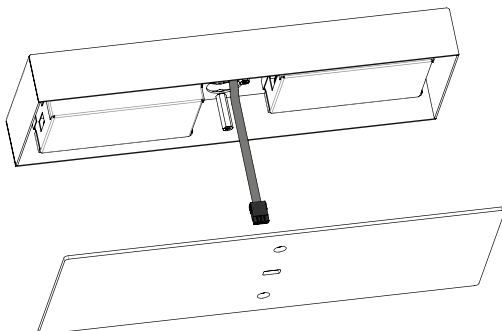



STEP 2

Mark the location of the suspension cables on the ceiling using the measurement below.

46 1/4 in
117,5 cm

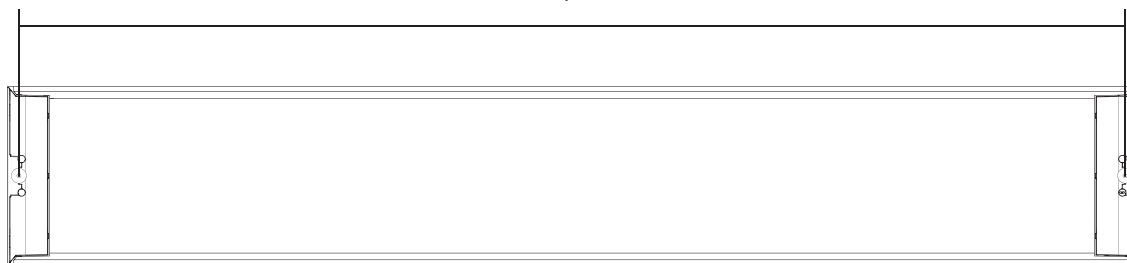

STEP 3

Install the cable couplers to the ceiling to the marked locations using the proper hardware (not supplied)

4x

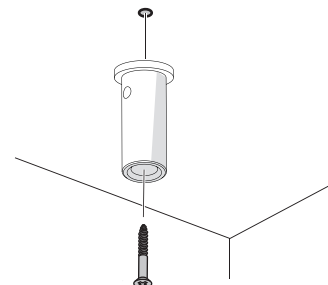
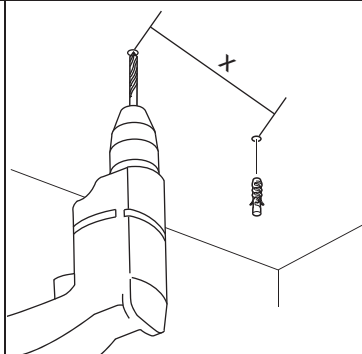
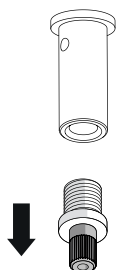

STEP 4

4.1 Loosen the gripper tip to allow insertion and insert the suspension cable through the gripper.
4.2 Feed the suspension cables into the coupler, then screw the gripper in. Repeat steps for all cables.

4.1

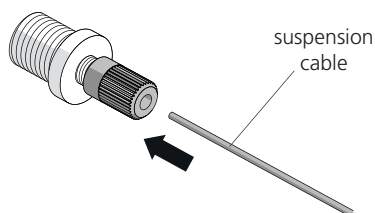
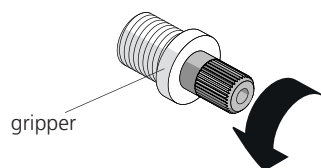

4.2

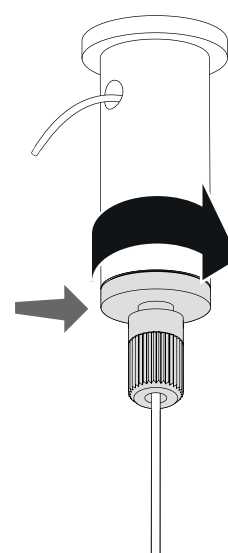
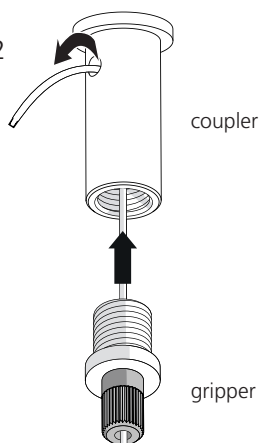



STEP 5

5.1 Loosen the bottom of the cable gripper in order to adjust fixture height. Pressing on it unlocks cable movement.
5.2 Once fixture is level enough, tighten bottom of the cable gripper in order to lock it into position.

5.1

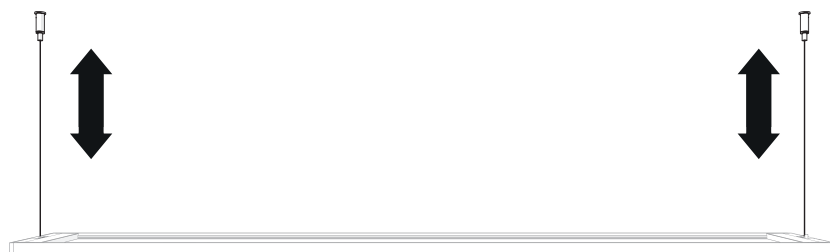
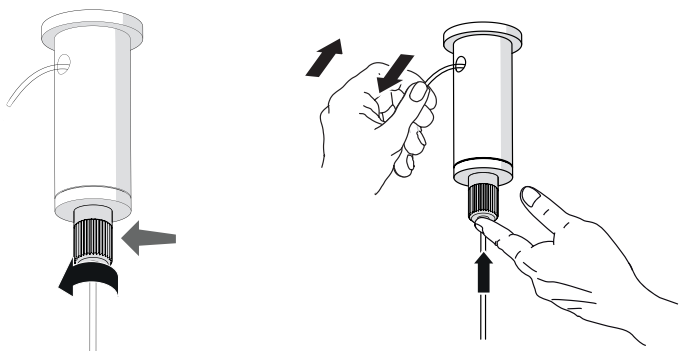

5.2

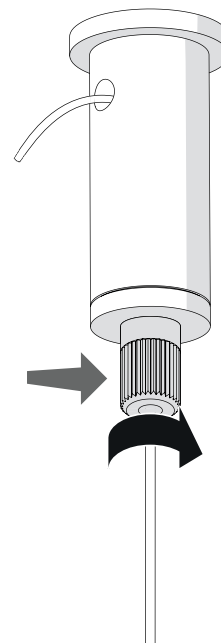

STEP 6

6.1 To level fixture in the other axis, you can move the suspension cable along the adjustment slots on the fixture.

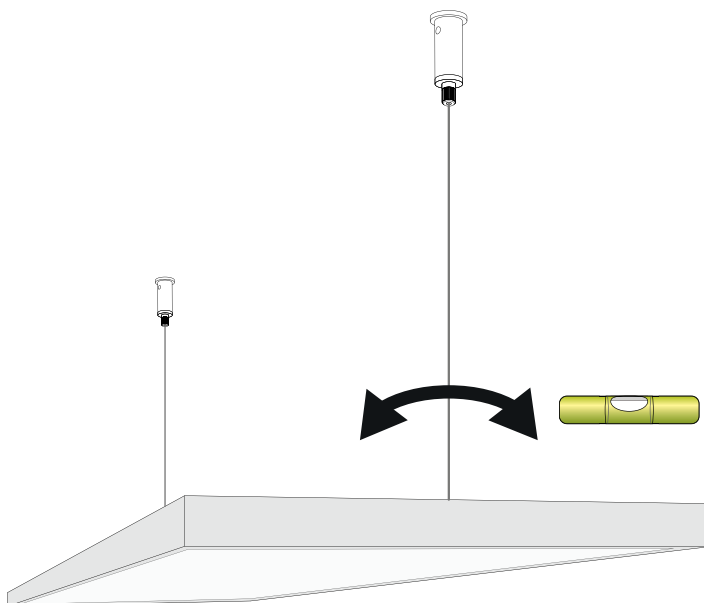
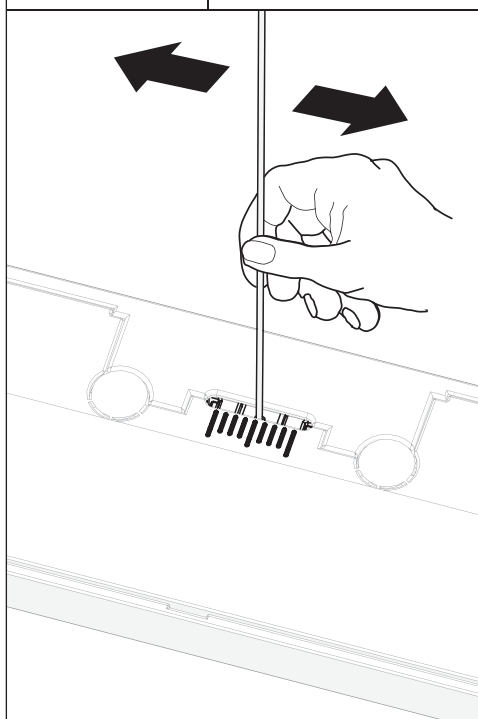



STEP 7

- 7.1 On the fixture, lift up the terminal cover to expose the wiring connections.
- 7.2 Remove the screw holding the strain relief bracket.
- 7.3 Insert electrical cable, clicking it into the connector labeled "A" and screw the strain relief bracket back in.

7.1

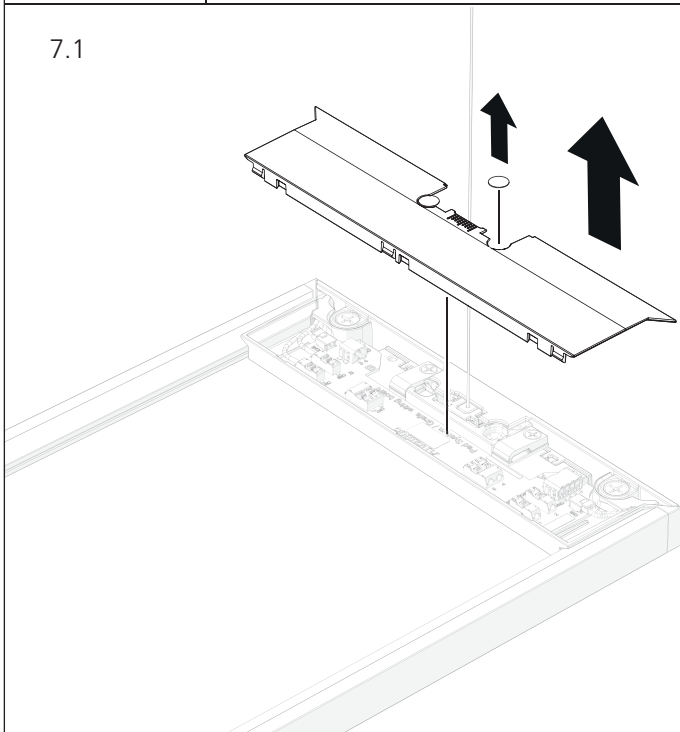

7.2

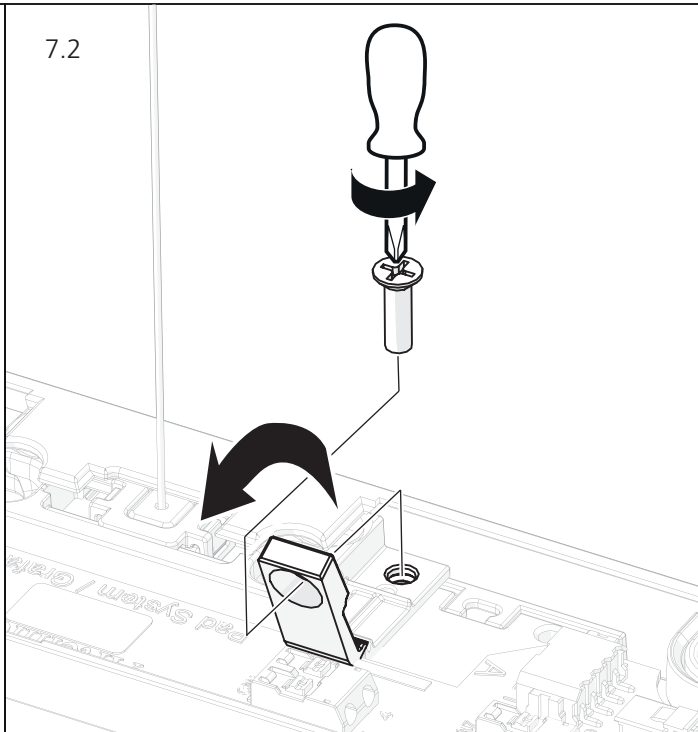

7.3

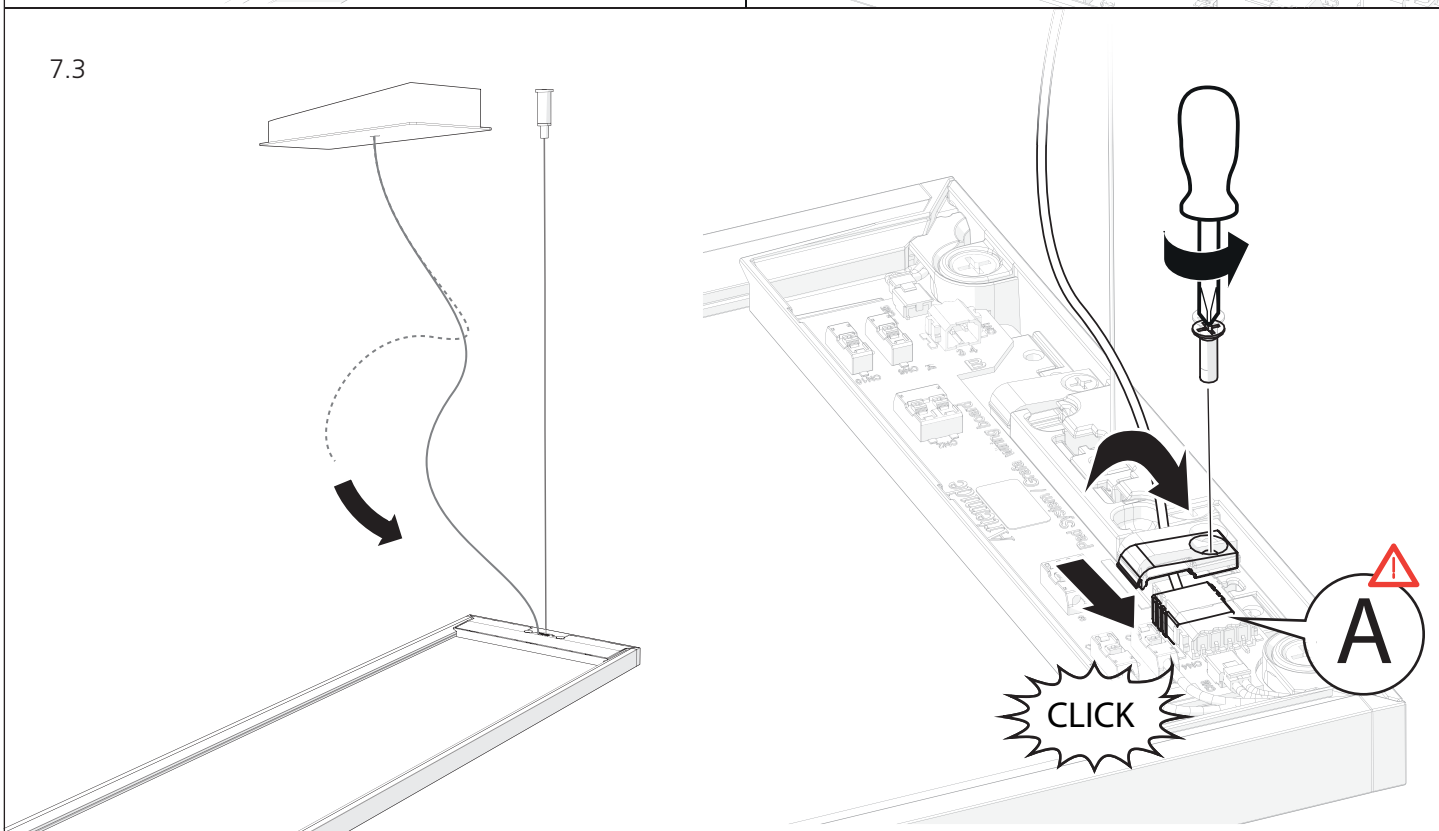



STEP 8

- 8.1 On the terminal cover, break off the small round cap corresponding to the side the wire will come out from.
8.2 Clip the terminal cover back on.
The fixture installation is now complete.

