



Attention: Read and understand these instructions before installing fixture. This fixture is intended for installation in accordance with National Electric Code and local regulation: To assure full compliance with local codes and regulations, check with your local electrical inspector before installation. This equipment is guaranteed only when used as indicated in these instructions; Therefore they should be kept for future reference. To prevent electrical shock, turn off power supply before carrying out any connection or maintenance operations.

STEP 1

Install canopy to the J-box

1. Unscrew part E
2. Remove part G
3. Unscrew part D
4. Make the appropriate electrical connection
5. Push the wires inside part A
6. Fix part C to part A with 8-32 screws (not included)
7. Screw part D to hold electrical wire

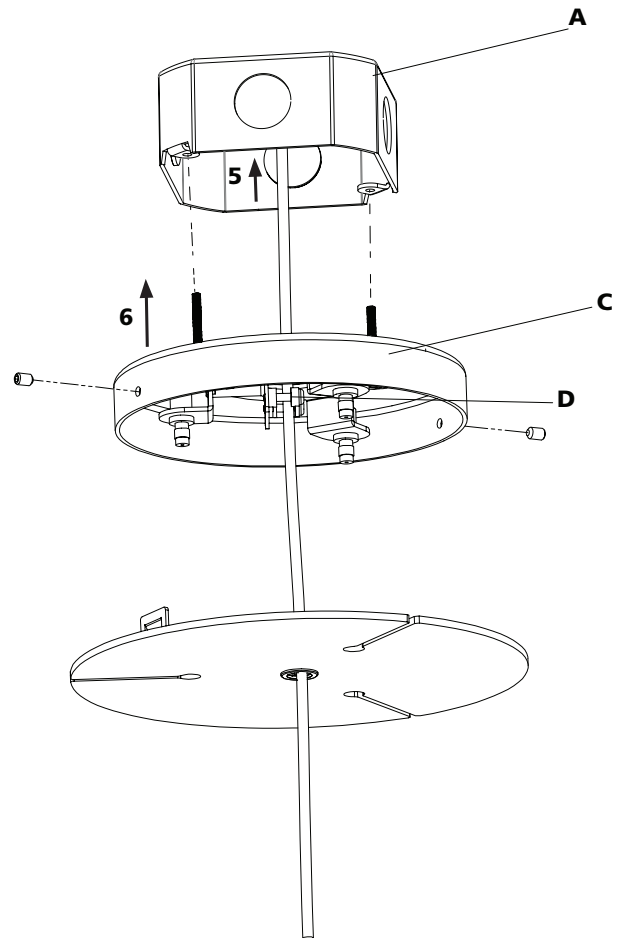
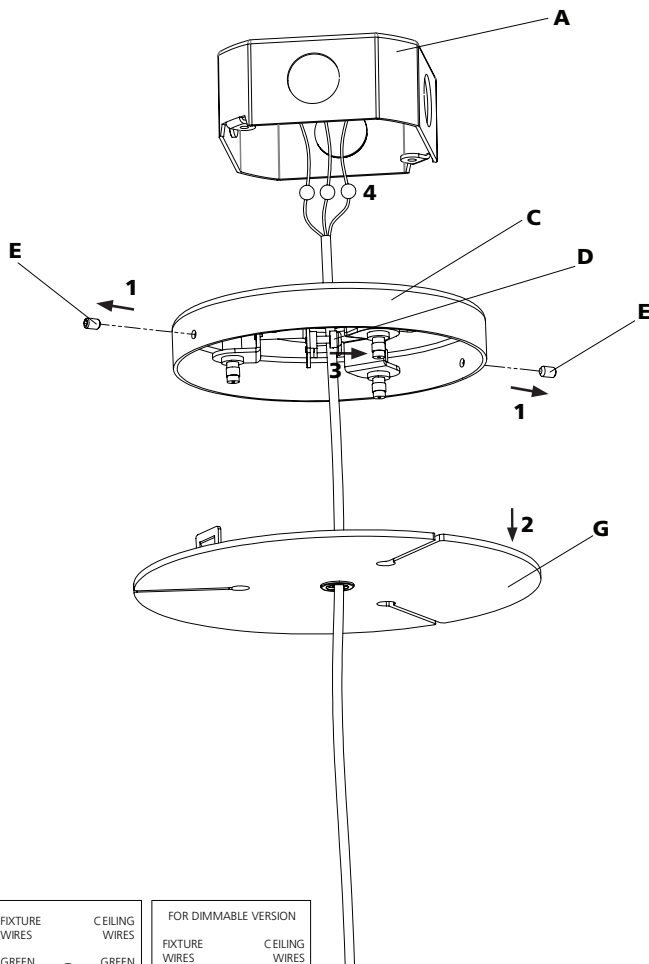

FIXTURE WIRES	CEILING WIRES	FOR DIMMABLE VERSION	
GREEN	GREEN	FIXTURE WIRES	CEILING WIRES
BLACK	BLACK	PURPLE +	0-10VDC +
WHITE	WHITE	GREY -	DC -



STEP 2

Steel cables adjustment

8. Loosen part H
9. Adjust all cables to required height
10. Tighten part H
11. Cut extra steel cables.

12. Fix part G to C (initial position)
13. Screw part E to hold Part G

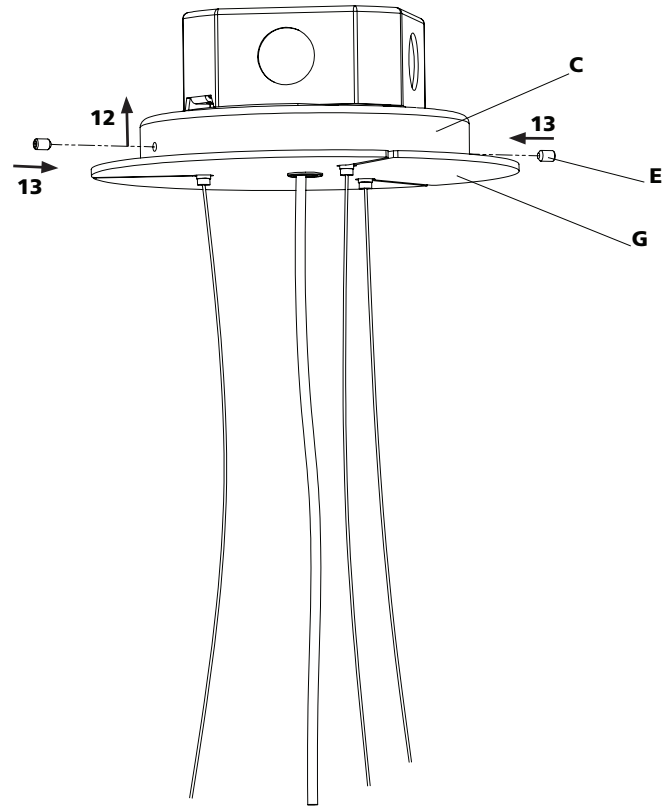
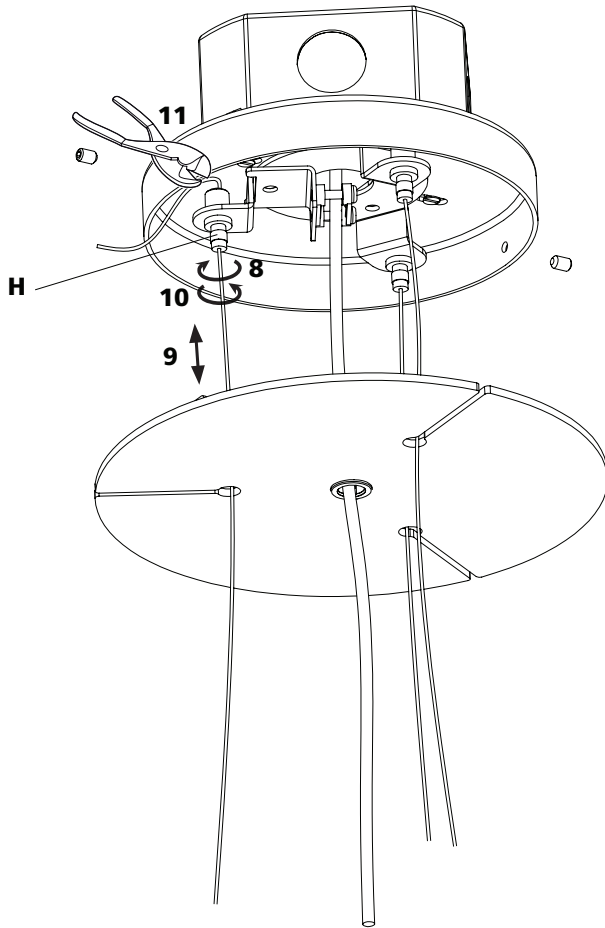



STEP 3

Install the body

1. Unscrew the diffuser holder
2. Remove the diffuser
3. Install the 4 fluorescent tubes as per schema below
4. Replace the diffuser to the initial position

