

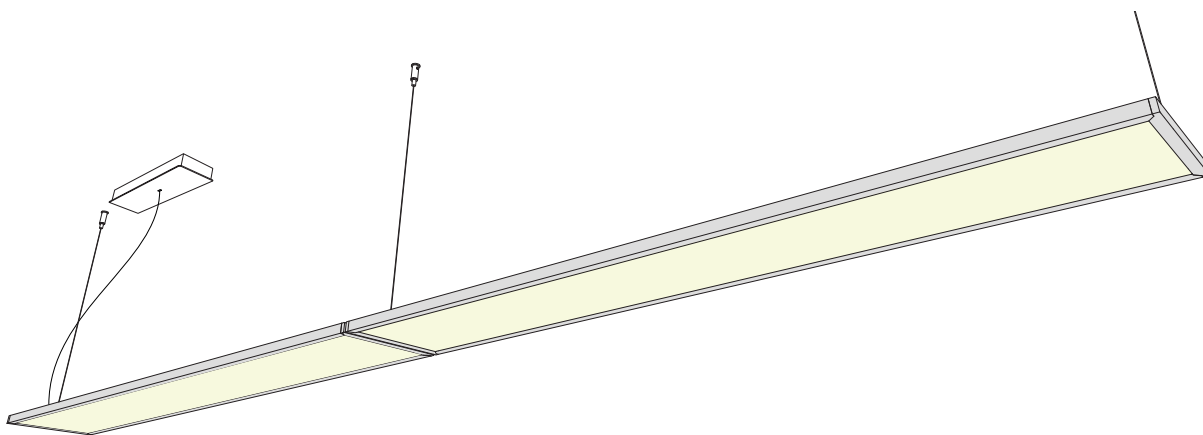

Attention: Read and understand these instructions before installing fixture. This fixture is intended for installation in accordance with National Electric Code and local regulation: To assure full compliance with local codes and regulations, check with your local electrical inspector before installation. This equipment is guaranteed only when used as indicated in these instructions; therefore they should be kept for future reference. To prevent electrical shock, turn off power supply before carrying out any connection or maintenance operations.

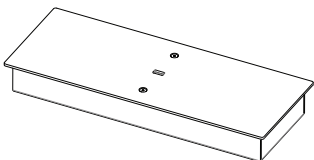
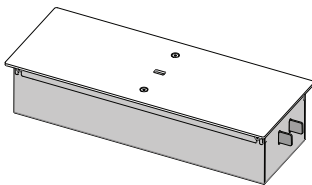
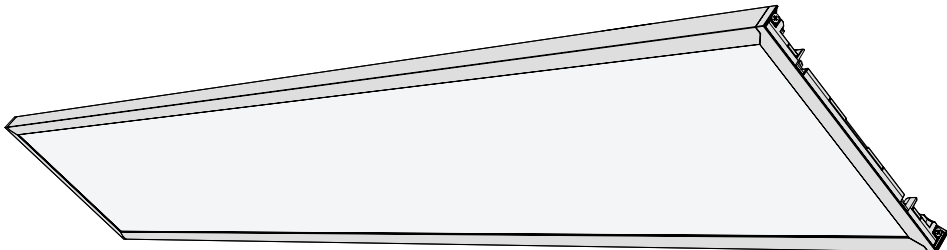
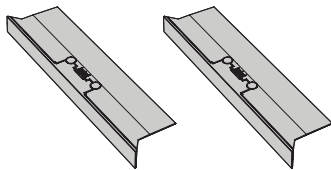
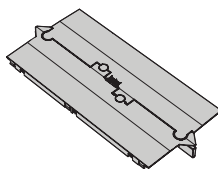
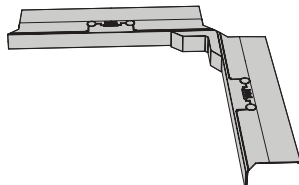

Make sure you have all the elements to complete the installation. Depending on configuration selected, you must have the following:

Driver Housing	<p>Surface model ————— OR ————— Recessed model</p>  		
Pad Fixture			
Joiner/End Cap	<p>End Cap</p> 	<p>Linear Joiner</p> 	<p>90° Corner Joiner</p> 



STEP 1 (cont.)

Depending on the configuration, establish where the housing(s) will be placed in order to feed the module(s).

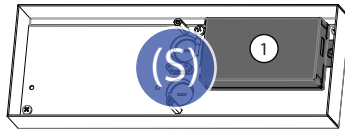

Allows connection of a single Pad fixture

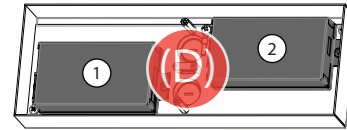

Allows connection of 2x Pad Fixtures as a system

1 Module = 1 Driver Housing with Single driver configuration (S)

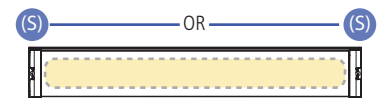

2 Modules = 1 Driver Housing with Dual driver configuration (D)

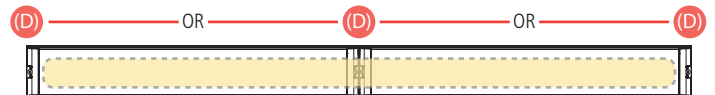

3 Modules = 2 Driver Housings, 1 with Single (S) and 1 with Dual (D) driver configuration.
(S) fed module must not be connected electrically with (D).

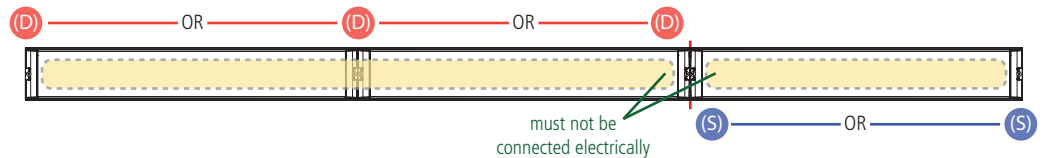

4 Modules = 2 Driver Housings with Dual driver configuration (D)
First (D) fed module must not be connected electrically with Second (D) module.

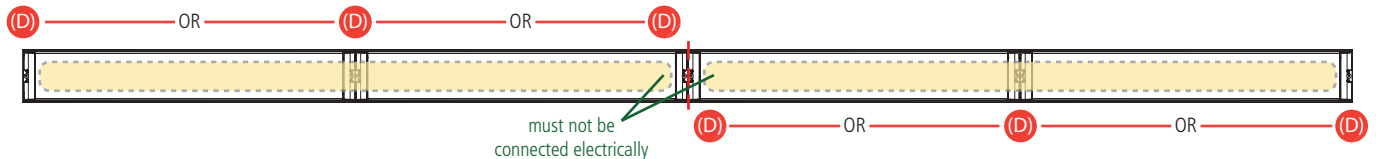



STEP 1 (Cont.)

Depending on the suspension brackets you use, the suspension points will have different spacing. Mark the location of the suspension points related to your configuration prior to installation using the information that follows:

Actual fixture dimensions for reference - Suspension points will vary with joiner type

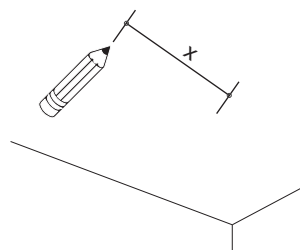
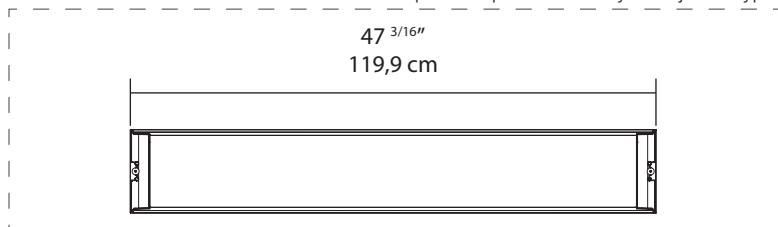

End Cap



Linear Joiner



Corner Joiner

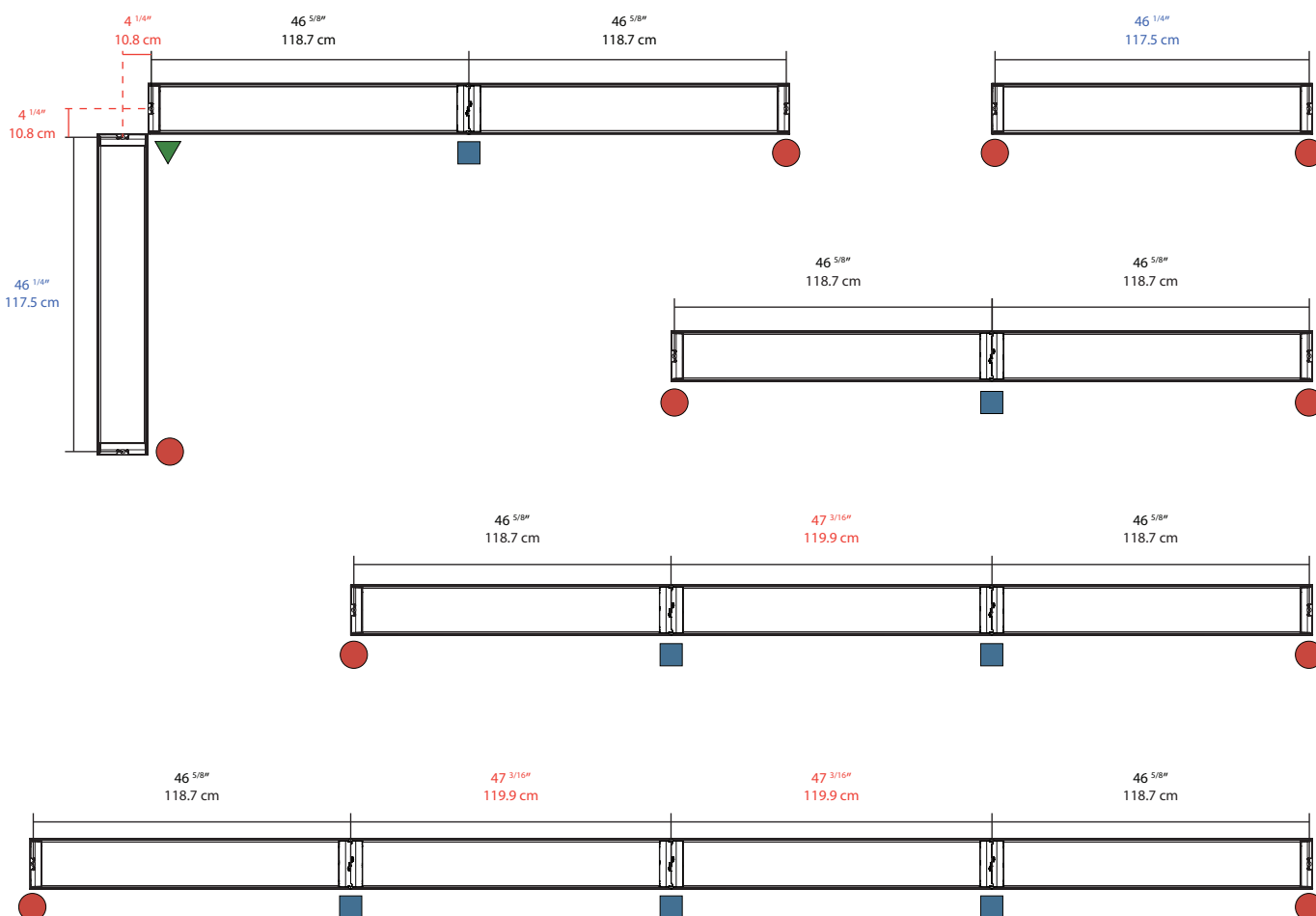



STEP 2

Install the Driver Housing(s) depending on your configuration, following the Instruction sheet supplied with it (document Y503-11401).

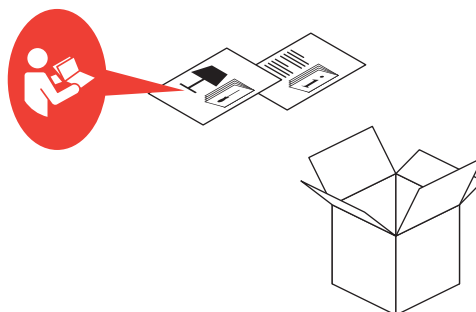
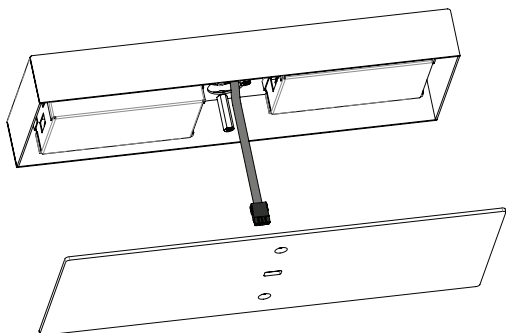

STEP 3

Install the suspension cable couplers to the ceiling to the marked locations using the proper hardware (not supplied)

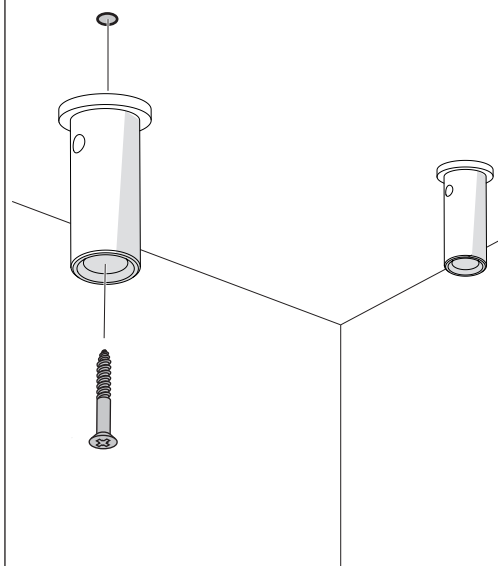
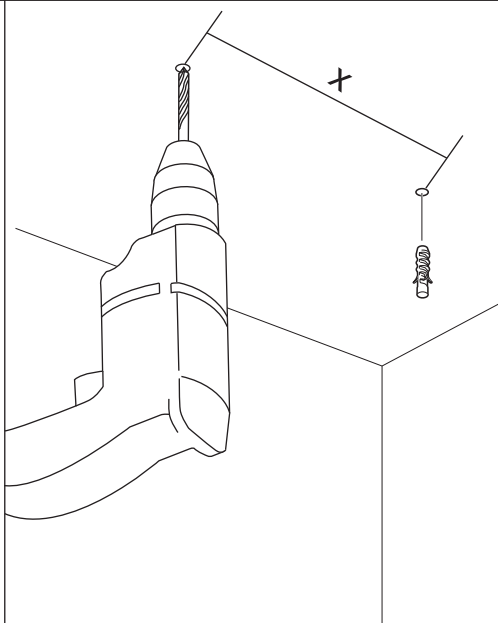



STEP 4

4.1 On the fixtures, remove the electrical connection covers

4.2 Depending on the configuration install the Joiners and End Caps as shown below

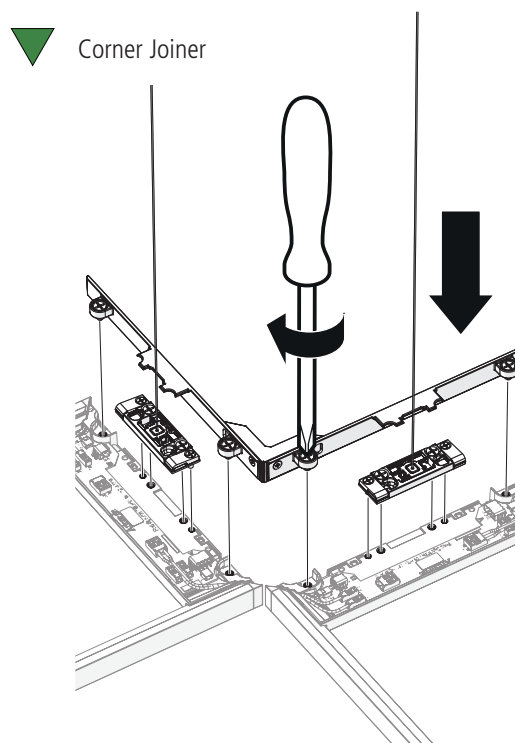
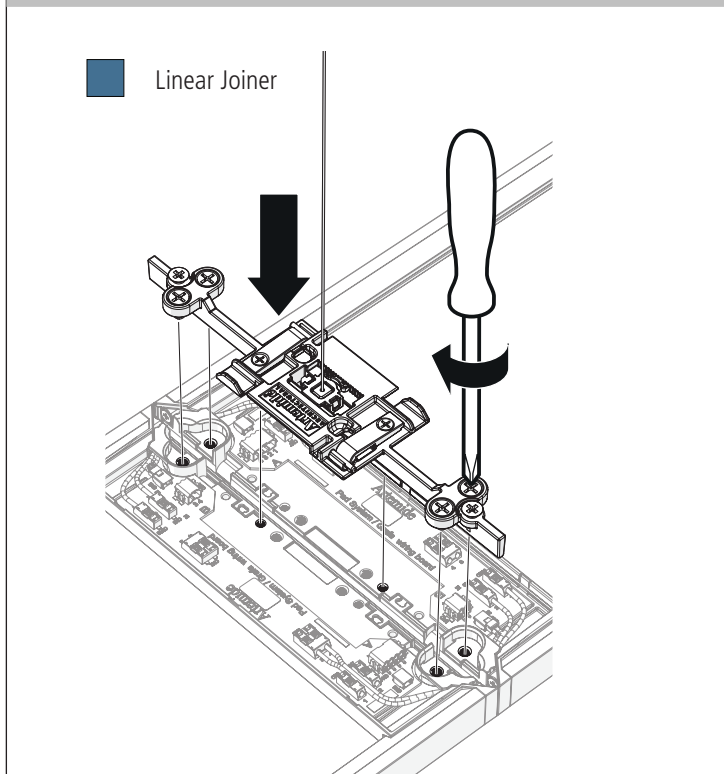
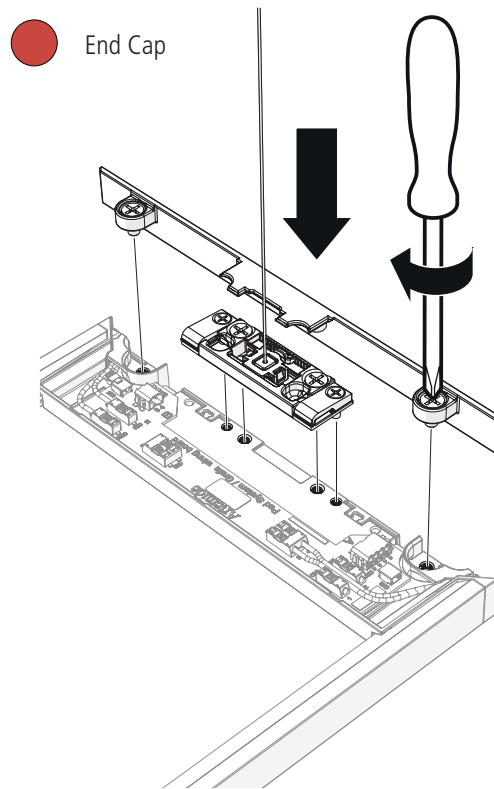
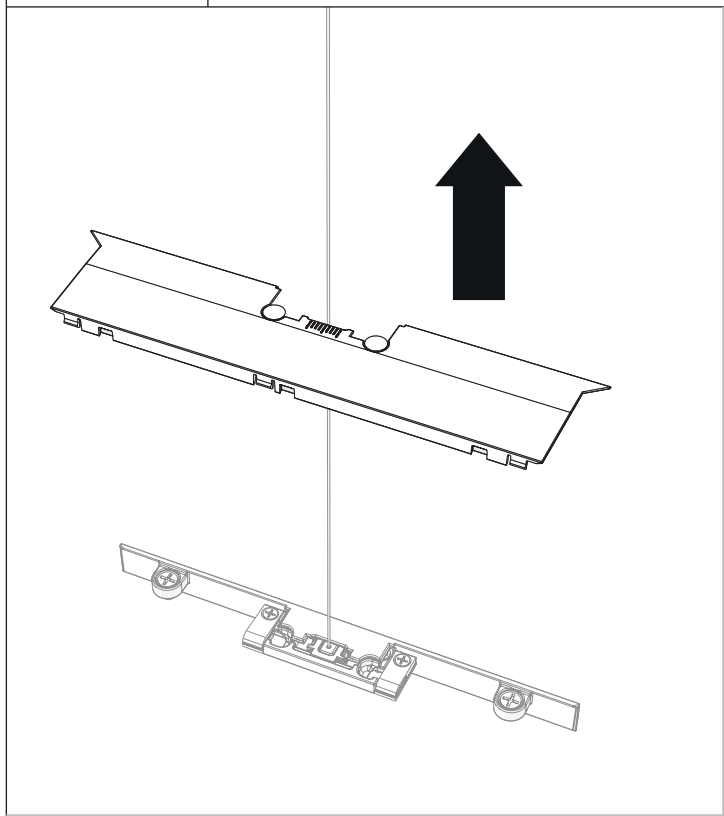



STEP 5

Feed the Suspension cables through the couplers and screw the grippers in.

5.2

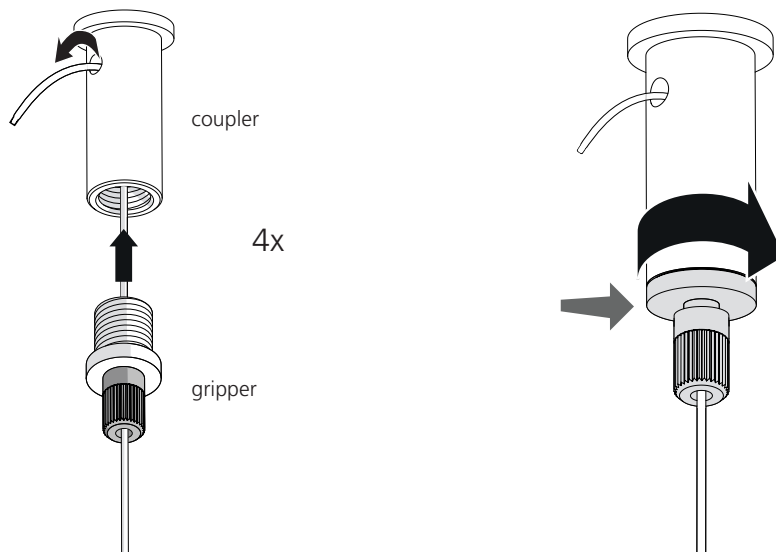

STEP 6

6.1 Loosen the bottom of the cable gripper in order to adjust fixture height. Pressing on it unlocks cable movement
6.2 Once fixture is level enough, tighten bottom of the cable gripper in order to lock it into position.

6.1

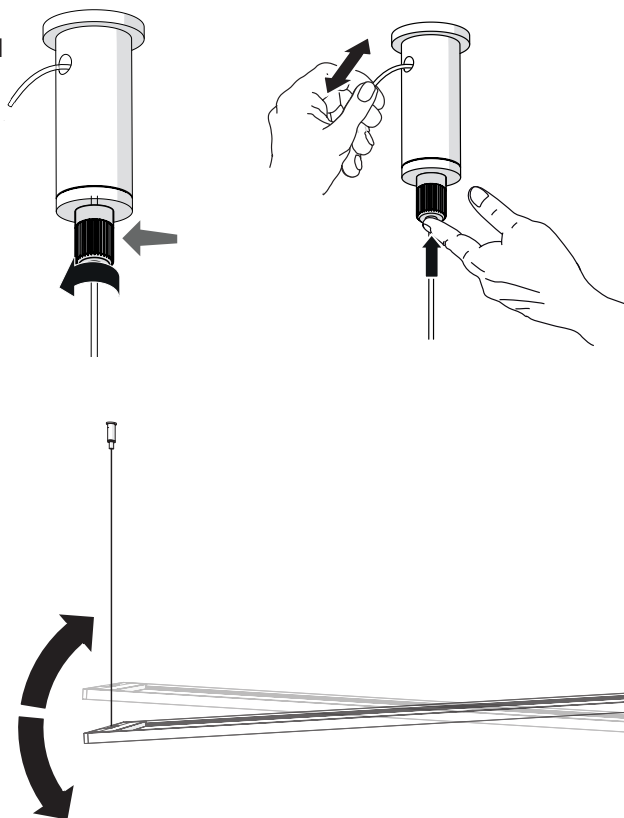

6.2

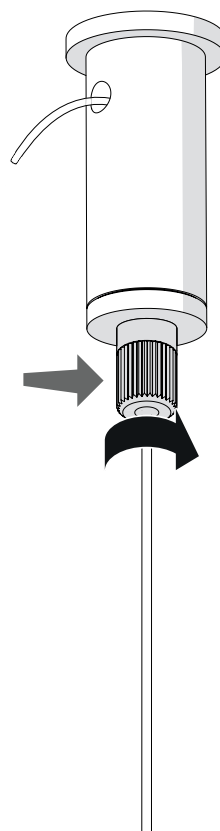



STEP 7

- 7.1 On the fixture, lift up the terminal cover to expose the wiring connections.
- 7.2 Remove the screw holding the strain relief bracket.
- 7.3 Insert electrical cable, clicking it into the connector labeled "A" and screw the strain relief bracket back in.

7.1

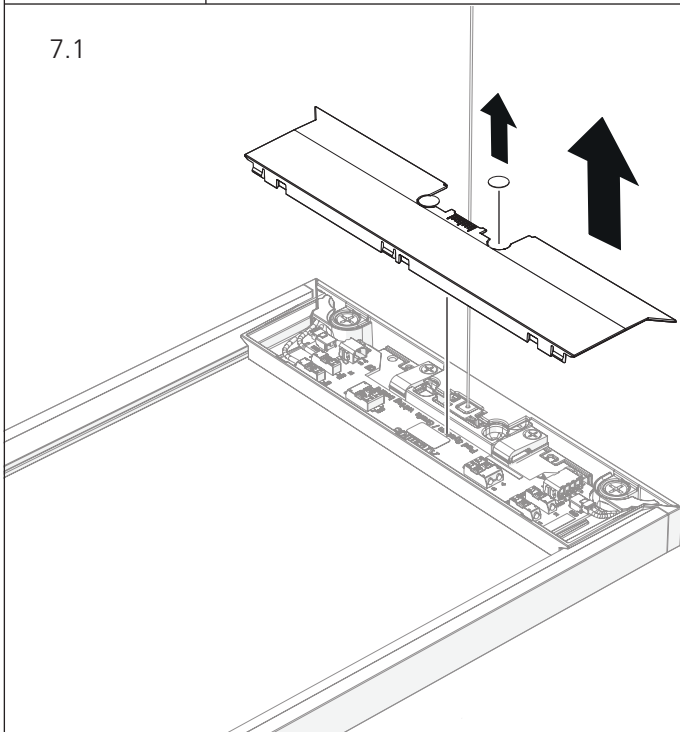

7.2

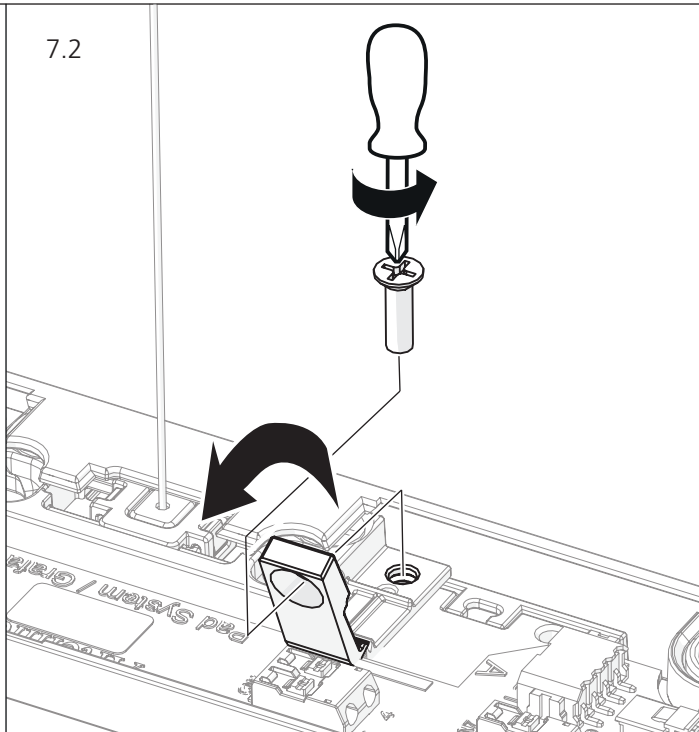

7.3

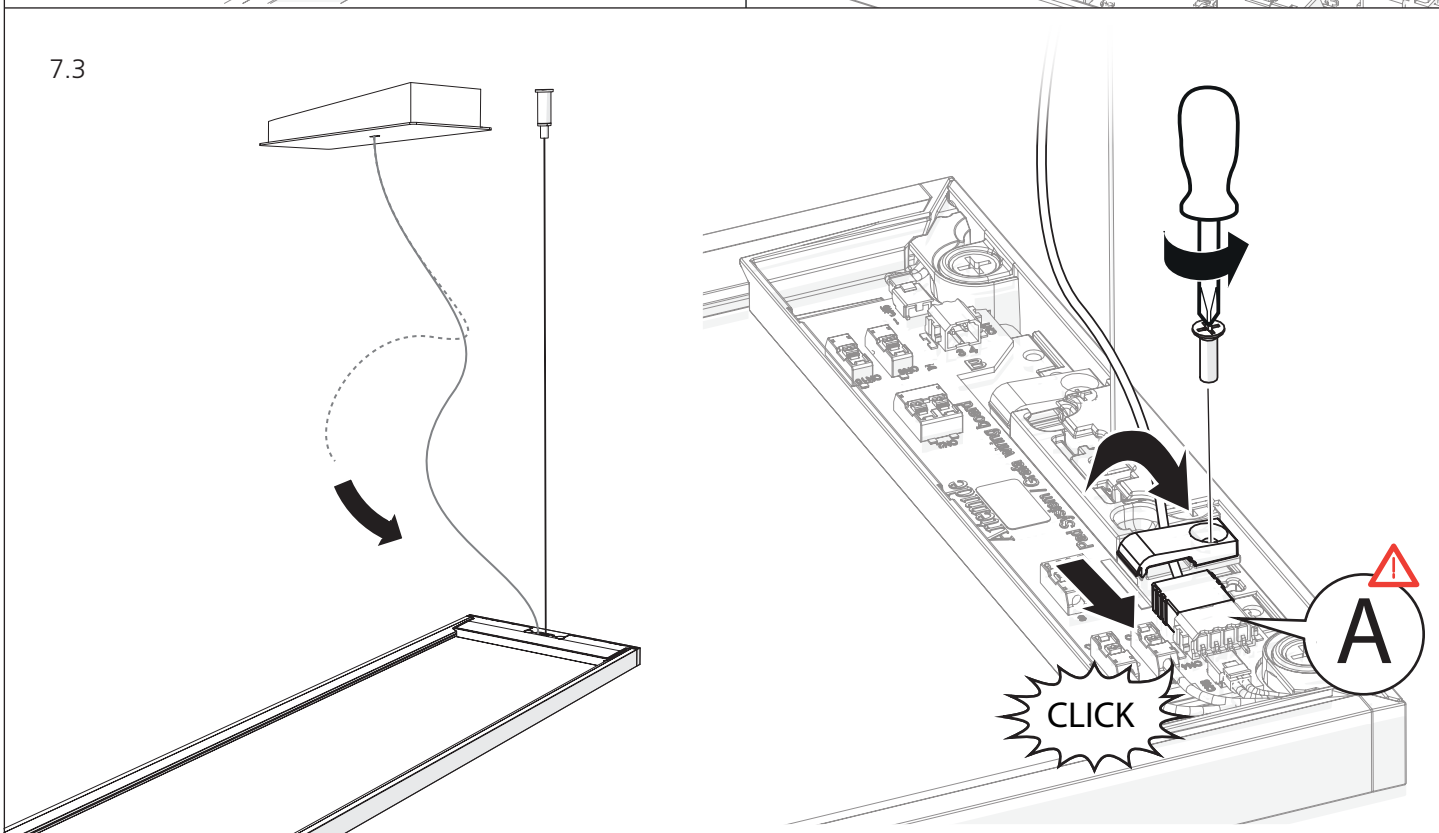



STEP 7 (alt)

7.4 To connect two modules electrically, provided you are using the correct 2-driver housing, use the small jumper cable that comes in the driver housing packaging. Connecting the 2-pin end of the jumper to the first fixture's B location, and the other end (4-pin) to the second fixture's A location, and

7.5 Place the covers back on. Installation is complete.

