

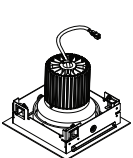

Attention: Read and understand these instructions before installing fixture. This fixture is intended for installation in accordance with National Electric Code and local regulation: To assure full compliance with local codes and regulations, check with your local electrical inspector before installation. This equipment is guaranteed only when used as indicated in these instructions; Therefore they should be kept for future reference. To prevent electrical shock, turn off power supply before carrying out any connection or maintenance operations.

Your box should contain the following parts:



MJAT1F-SERIES

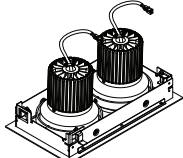

MJAT2F-SERIES

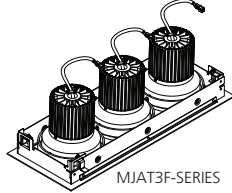

MJAT3F-SERIES

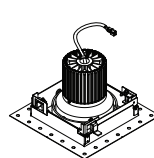

MJAT1FL-SERIES

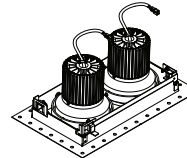

MJAT2FL-SERIES

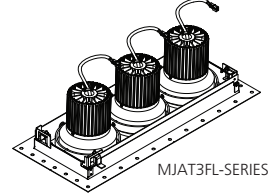

MJAT3FL-SERIES

STEP 1

TRIM FLANGELESS

- 1.1 Insert plaster trim inside frame aperture.
- 1.2 Plaster trim can be align using laser with alignment notches on each side.

- 1.3 Install plaster trim using self-tapping drywall screws.
- 1.4 Screws must be intalled through the frame bottom plate.

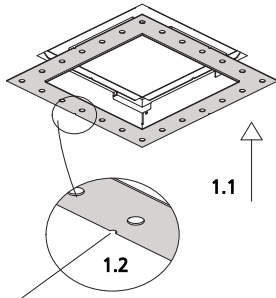

Alignment notch

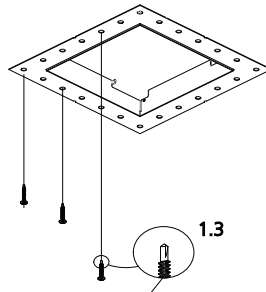

Self-tapping screw

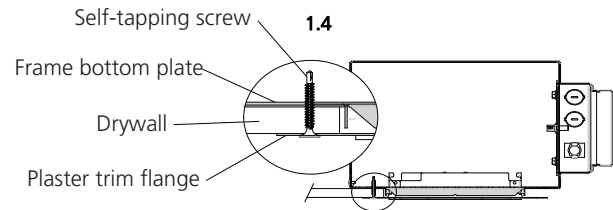

- 1.5 Cover flange with plaster / joint compound. Paint before trim installation.
- 1.6 Connect trim to the frame by using connectors.

- 1.7 Insert trim inside frame aperture.
- 1.8 Rotate 4 trim mounting feet outward once the trim is flush to ceiling.
- 1.9 Hold the trim flush to ceiling surface while tightening the mounting feet screws.

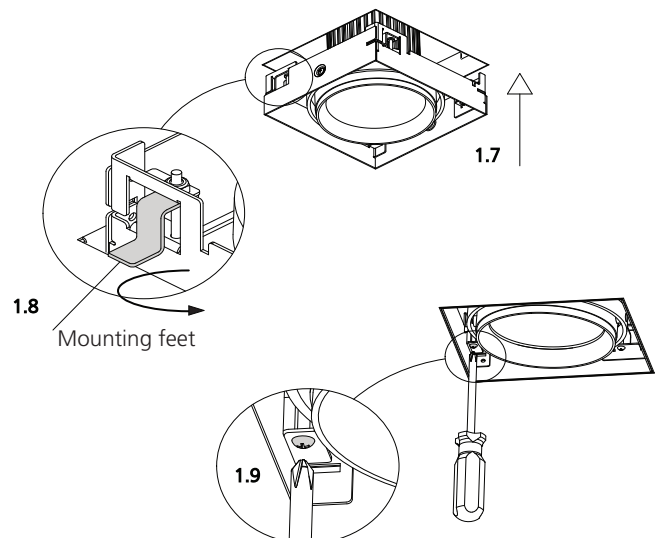
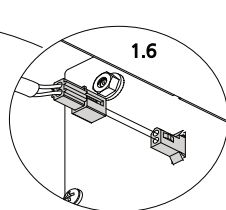
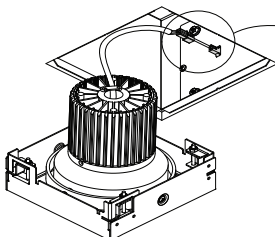
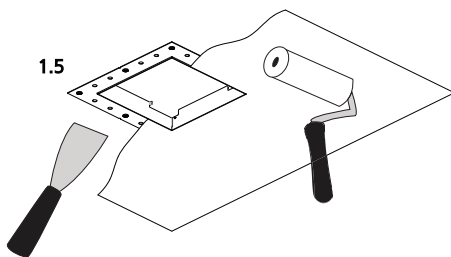



STEP 2

TRIM WITH FLANGE

- 2.1 Connect trim to the frame by using connectors.
- 2.2 Insert trim inside frame aperture.
- 2.3 Rotate 4 trim mounting feet outward once the trim is flush to ceiling.
- 2.4 Hold the trim flush to ceiling surface while tightening the mounting feet screws.

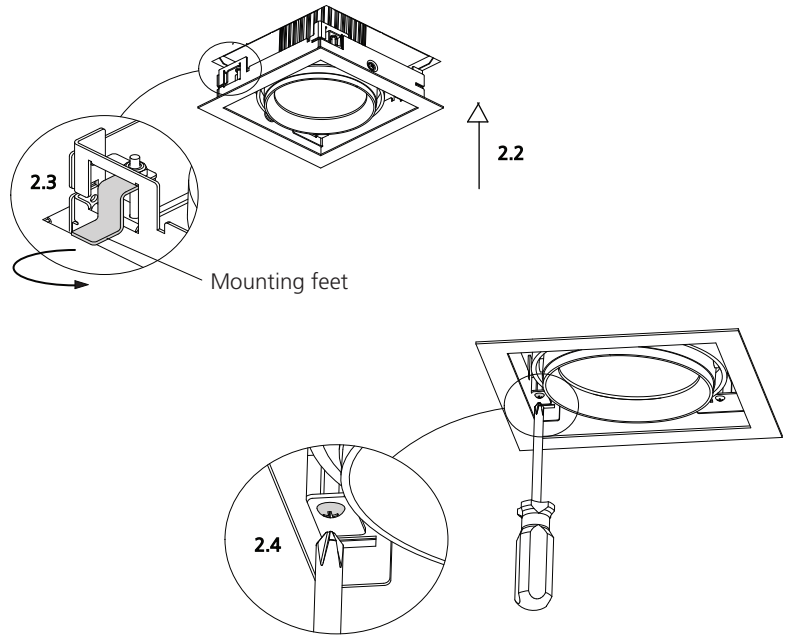
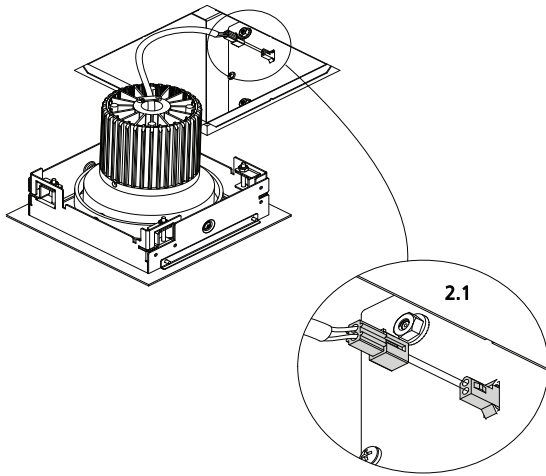

STEP 3

REFLECTOR REPLACEMENT

- 3.1 Remove reflector holder by pulling downward.
- 3.2 Remove reflector by pulling upward.
- 3.3 Replace reflector

